

REMOVAL

1. REMOVE STEERING WHEEL PAD

NOTICE:

If the airbag connector is disconnected with the ignition switch at ON or ACC, DTCs will be recorded. Never use airbag parts from another vehicle. When replacing parts, replace with new parts.

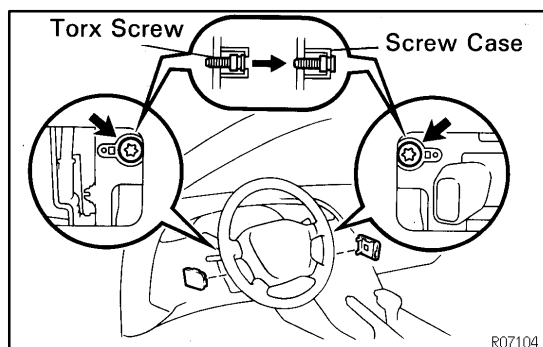

- Place the front wheels facing straight ahead.
- Using a torx socket wrench, loosen the 2 torx screws.

HINT:

Loosen the 2 screws until the groove along the screw circumference catches on the screw case.

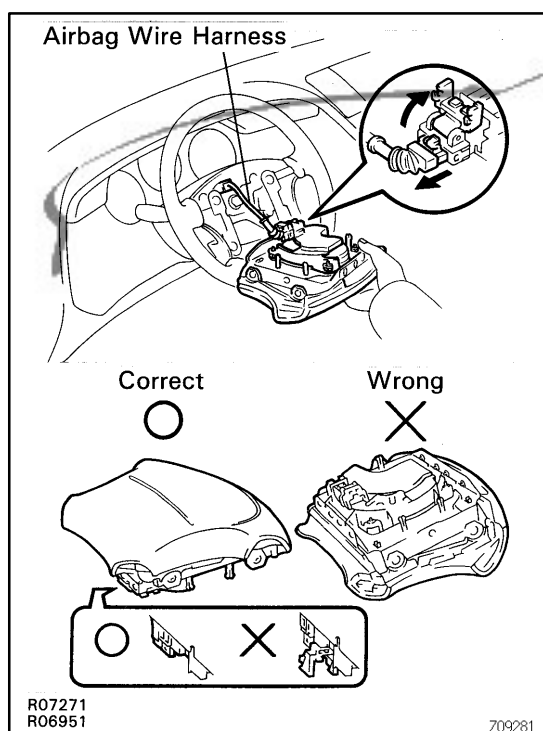

- Pull the pad out from the steering wheel and disconnect the airbag connector.

CAUTION:

When storing the pad, keep the upper surface of the pad facing upward. Never disassemble the pad.

NOTICE:

When removing the pad, take care not to pull the airbag wire harness.

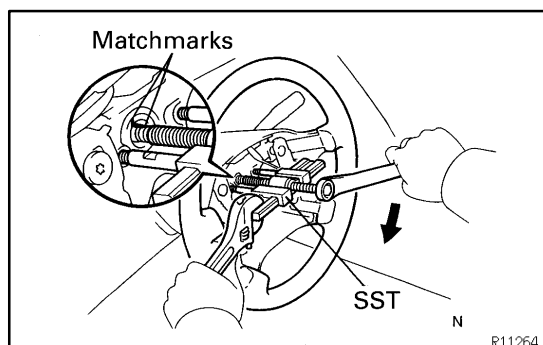

2. REMOVE STEERING WHEEL

- Disconnect the connector.
- Remove the wheel set nut.
- Place matchmarks on the wheel and main shaft.
- Using SST, remove the wheel.

SST 09950-50010 (09951-05010, 09952-05010, 09953-05020, 09954-05020)

3. REMOVE UPPER AND LOWER COLUMN COVERS

Remove 5 screws.